



User's Guide



User's Guide for Mobile Scanner – Flip-Pal™ 100C

Legal and notice information

© Copyright 2011 Couragent, Inc.

The information in this manual is subject to change without notice.

The only warranty for this product is set forth in the express warranty statement accompanying the product. Nothing in this manual should be construed as constituting an additional warranty. Couragent, Inc. shall not be liable for technical or editorial errors or omissions contained herein.

- "FLIP-PAL™" and the Flip-Pal™ logo are trademarks of Couragent, Inc.
- Windows® is a U.S. registered trademark of Microsoft Corporation.
-  and  logos are trademarks of SD-3C, LLC.
- Other names and products not mentioned above may be registered trademarks or trademarks of their respective companies.

Table of Contents	3
1 Introduction	4
Meet the Flip-Pal™ Mobile Scanner	4
What's In the Box?	4
Scanner Overview	4
2 Setup and Overview	5
Apply Window Protector Sheet (Optional)	5
Activate the Batteries	5
Power On and Off	5
Set Date and Time	6
Home Screen	6
Review Screen	6
Menu and Status Bar	7
Customizing Settings	7
Setting the Resolution	8
Setting the Power-Saver Timer	8
Quick Tips	8
Customizing the Home Screen	8
3 Scanning and Reviewing	9
Standard Scanning	9
Flip and Scan	9
Scanning Large Originals	10
Reviewing Scans	11
4 Using Scans	12
Flip-Pal™ Software on the SD Card	12
How to Transfer and Delete Scans	13
How to Stitch Large Originals with Flip-Pal™ EasyStitch Software	14
How to Restore Color to Faded or Yellowed Photos	14
How to Upload Scans to Facebook	15
How to Order Prints	15
5 Specifications	16
Battery Information	16
Supported Batteries and Battery Life	16
Replacing Batteries	16
Extending Battery Life	16
SD Memory Cards	16
Other Uses for the SD Memory Card	17
Product Care	17
Operating System and Browser Support	17
Accessories and Replacement Parts	17
Troubleshooting	18
Customer Support	18
Limited Warranty	18
Disclaimer	19
Declaration of Conformity	19
Appendix A – Flip-Pal™ EasyStitch End-User Software License Agreement	20

Meet the Flip-Pal™ Mobile Scanner

With the Flip-Pal™ mobile scanner, no longer will your precious photos and other memories be scattered or lost. Have fun, enhance your creativity and share your memories with family and friends. Use it like a traditional scanner, or take advantage of the multi-use, patented flip-and-scan technology.

Scan anywhere, anytime. Enjoy its versatility in scanning large documents and even small objects. Appreciate how the scans look just like the original. Save time and keep your photos safe by scanning them while still in an album or frame.

What's In the Box?

Your Flip-Pal™ mobile scanner comes with everything you need to scan photos, drawings and other documents. Included with the scanner are:

- Flip-Pal™ Model 100C Mobile Scanner
 - Four AA batteries (installed)
 - 2GB SD memory card (installed) which stores your scans and also contains Flip-Pal™ Software. To remove it, push it in gently; it will spring out, allowing you to slide it out.
- SD Memory Card to USB adaptor
- Quick Start Guide

Scanner Overview

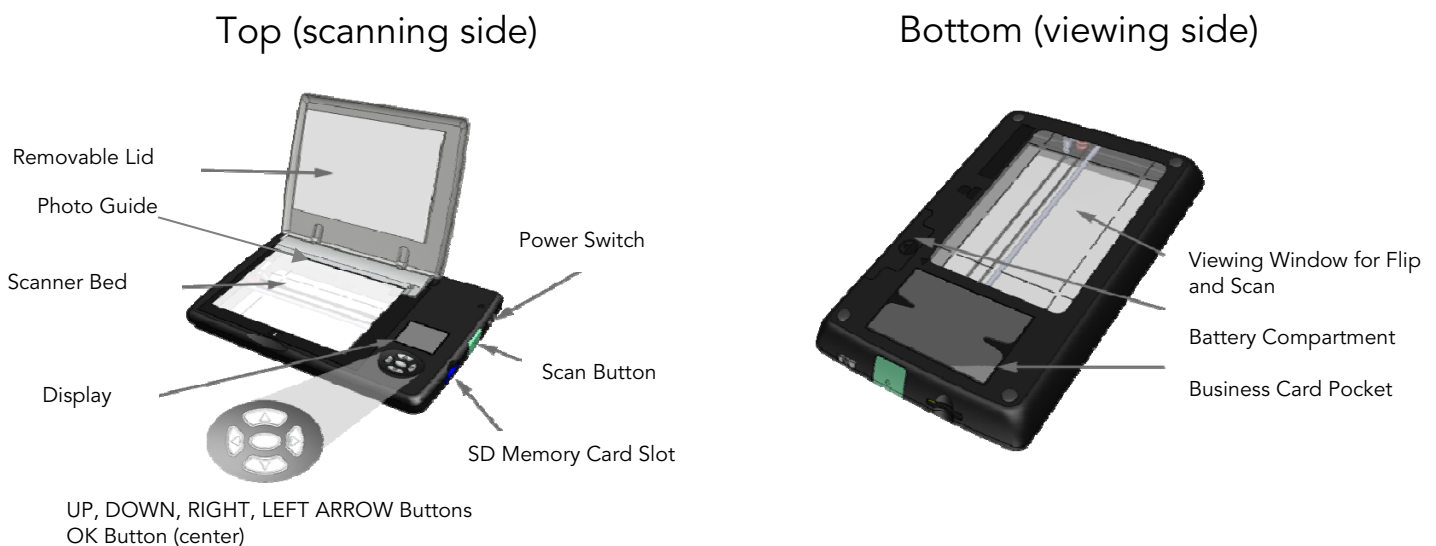

Apply Window Protector Sheet (Optional)

The bottom viewing window is made of a strong, scratch-resistant plastic. It may get scratched when carrying the scanner around. You can protect it with either a carrying case or by applying an optional window protector sheet.

The window protector sheet provides additional protection against scratches to the **bottom viewing window**. **Do not apply it to the scanner bed.** To apply it, follow these steps:

1. Clean the bottom viewing window of any dirt or fingerprints if needed.
2. Peel corner of the protector sheet away from the backing. Align sheet along one side of the bottom window, matching the corners. Carefully hold the protector sheet at the corners when applying to eliminate any oils or fingerprints that may remain on the protector.
3. Lay the sheet down while sliding a credit card across the window protector to apply. To reposition, gently lift up and reapply. Any "bubbles" remaining after you smooth out the sheet will not affect scan quality.
4. Replace window protector as needed. Replacement sheets can be ordered from www.flip-pal.com.



Activate the Batteries

The scanner is shipped ready to use with four AA batteries. To activate them, remove the battery-protect tab by pulling the plastic tab protruding through the small gap in the battery door, located on the bottom of the scanner. It is not necessary to open the battery door to pull the tab out.



Press gently on battery door while pulling tab sideways to remove

Power On and Off



Slide the spring-loaded power switch toward rear, hold until the display lights up, then release

When you are done using your scanner, move the power switch toward the back of the scanner to power it down. The scanner will also power down automatically, based on the Power-Saver Timer setting (default is 2 minutes). On newer models, it will power down after 5-10 seconds if the SD memory card is removed.

NOTE: On some older scanners, the screen dims after 60 seconds of not being used, to save battery power. Pressing any button will return the screen to full brightness.

Set Date and Time

The scanner performs a quick self-test then asks you to set the date and time. Here is the screen you will see.

Use UP ARROW and DOWN ARROW to change the value within each field. Use LEFT ARROW and RIGHT ARROW to scroll to each of the fields in turn, starting with Month and ending with AM/PM.

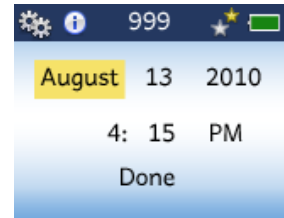

When you are satisfied with all settings, move the highlight to **Done** and press OK to save the settings and go to the **Home Screen**. If you want to skip this step, you can just press the green scan button; the scanner will use either the default date and time, or the latest one set.

Home Screen



Review Screen

After you have scanned, you will see the **Review Screen**, with the most-recently scanned image.

Use LEFT ARROW to scroll backwards through previous scans and RIGHT ARROW to scroll forward.



Menu and Status Bar

The bar at the top of the screen shows menu choices and status icons:

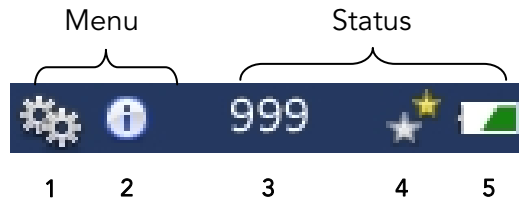

Menu	Status
1. Custom Settings: <ul style="list-style-type: none"> Resolution Power-Saver Timer 2. Quick Tips: Reminders on how to use the scanner.	3. Estimated Scans Remaining: 4. Resolution Indicator: <ul style="list-style-type: none"> 1 yellow star: 300 DPI: fastest scan, smaller file 2 yellow stars: 600 DPI: more detail, good for enlargements 5. Battery Life Indicator

Customizing Settings

There are two settings that you can customize:

Resolution	1 star = 300 DPI* 2 stars = 600 DPI
Power-Saver Timer	1, 2*, or 10 minutes before scanner powers down when not in use. Use a shorter setting to help preserve battery life. Use the 10-minute setting when transferring a large number of scans with a wireless SD memory card (available from third parties).

*Default Settings

To access the Settings menu, press UP ARROW from either the Home or Review Screen, then press DOWN ARROW to get into the settings menu. You will see the following screen. Current settings are indicated with a green checkmark.



Setting the Resolution

From either the *Home or Review Screen*:

- Press UP ARROW to highlight the Settings icon. The current or factory settings will have a checkmark above them.
- Press DOWN ARROW to move into the Resolution (dpi) menu.
- Use RIGHT ARROW to highlight the desired resolution setting
- Press OK to select.
- Press OK again to move back to the Home Screen or the Review Screen, if there are images to review *or* Press DOWN ARROW to move to the Power-Saver Timer setting.

Setting the Power-Saver Timer

From the *Resolution setting (above)*:

- Press DOWN ARROW to move to the Power-Saver Timer setting.
- Use RIGHT or LEFT ARROW to highlight the desired timer setting.
- Press OK to select.
- Press OK again to move back to the Home or Review Screen.

Quick Tips

To see a variety of tips on using your scanner, from the Home or Review Screen, press UP ARROW then RIGHT ARROW to move to Quick Tips. You will see the Contents Screen similar to this.

Use UP or DOWN ARROW to scroll through the contents. Press OK to view the Quick Tip for that topic. If a topic takes more than one screen press RIGHT ARROW to move to the next screen.

After reading a Quick Tip, you can:

- Press LEFT ARROW to go back to the index
- Press UP ARROW or DOWN ARROW to scroll through all the tips
- Press OK to return to the Home or Review Screen

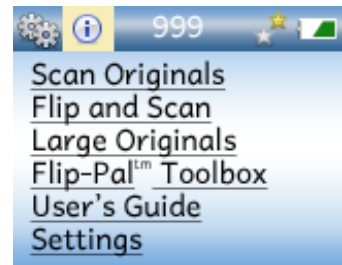

Customizing the Home Screen

You can use one of your own images for the Home Screen. It can be any JPEG file with an image that is 160 pixels wide by 106 pixels tall. The name must be **MyScanner.jpeg**. Store it in the top level of the SD memory card. Visit www.flip-pal.com for more information.

Standard Scanning

You can scan originals up to 4x6 inches.

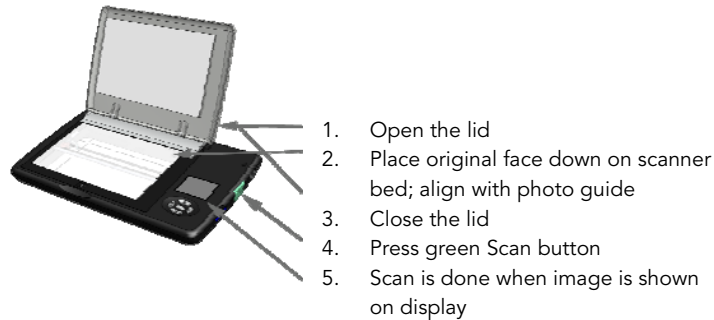

The scan is stored on the SD memory card and the scanner will be in Review mode. Scanning is complete when the entire image is displayed.

To help ensure that the scan is straight, align the original with the photo guide on the lid as shown.



Flip and Scan

Flip scanning allows you to scan a photo in an album or frame, scan large originals for stitching together later on your computer, or scan small objects such as coins. To flip and scan:



When the scan bar stops its forward motion, the scan is done and you can move the scanner.

Scanning Large Originals

For originals larger than 4x6 inches, you can take multiple scans of the original, then stitch them together later on your computer using Flip-Pal™ EasyStitch software. (see How to Stitch Large Originals in Chapter 4.)

Remove the lid and flip the scanner over. Make multiple scans, allowing **at least 1 inch or more** overlap between adjacent scans. The overlaps need not be aligned or spaced precisely; the stitching software compensates for that. It is OK to scan past the edge of the photo. Be sure to keep the scanner still during each scan.

You can use the lines etched in the bottom window to align the overlaps.

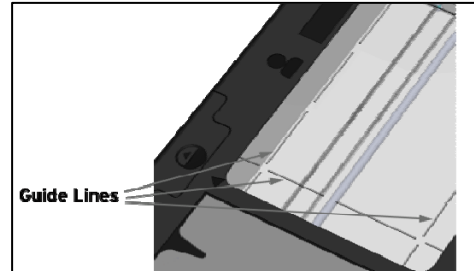

If you are scanning something like a framed photo it is acceptable to rotate the scanner along one edge to capture the entire image. The EasyStitch software will rotate individual scans as needed to ensure proper stitching of the final image.

Example:

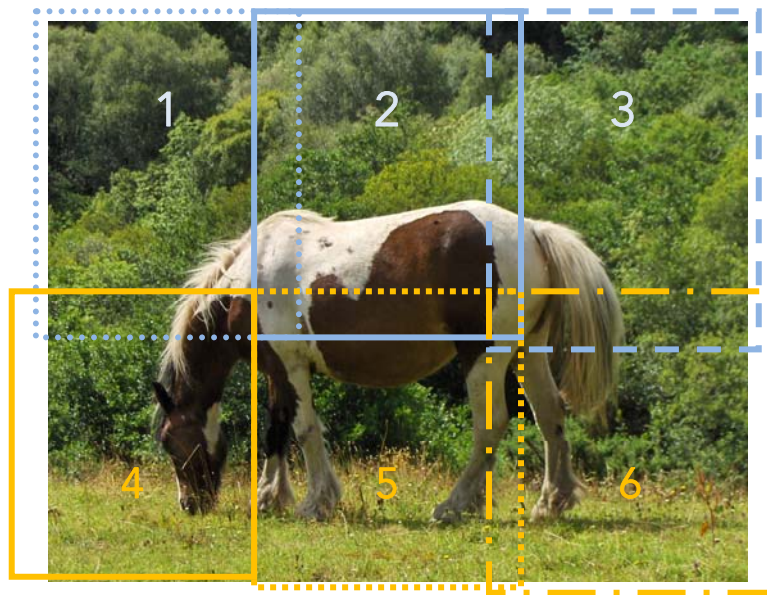

These scans can then be stitched together to form one image.

Reviewing Scans

After you scan, the scanner will automatically be in Review mode. To access Review mode from the Home or Menu Screen, press OK. Use LEFT ARROW to scroll backwards through previous scans and RIGHT ARROW to scroll forward.

When you get to the first scan, pressing LEFT ARROW brings you to this screen.

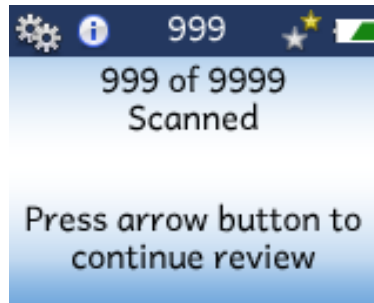

Press LEFT ARROW to go back to the last scan, or RIGHT ARROW to go back to the first scan.

The Flip-Pal™ mobile scanner stores scans on the SD memory card the same way your digital camera does. When you are ready to use your scans, simply transfer them to your computer and use them just like any digital photo or image – crop, rotate, adjust color, print, etc.

To remove the SD card from the scanner, push it in gently. It will then spring out slightly, allowing you to slide it out. **It is recommended that you power off the scanner before removing the SD card.** If you remove the SD card while the scanner is on, you will get a warning message "Insert Card/Power On", then the scanner will turn off after 5-10 seconds.

When you are done using your scans on your computer, you can return the SD card to the scanner.

NOTE: Please refer to your computer's documentation for the recommended way to safely eject and remove the SD card from your computer's SD slot. Failure to do so could result in the loss of your scans.

Flip-Pal™ Software on the SD Card

NOTE: The following information for Windows and Mac users assumes that you have the latest version of the Flip-Pal™ Software on your SD card. Please go to www.flip-pal.com for more details, which can be found on the Downloads page in Customer Care.

Windows Users

Flip-Pal™ Toolbox for Windows provides a variety of tools for transferring and using scans, as well as getting help. Flip-Pal™ Toolbox runs directly from the SD memory card. You **do not** need to install it on your computer. It enables you to:

- View or print the Flip-Pal™ documentation
- Stitch scans together to reconstruct larger originals with Flip-Pal™ EasyStitch
- Access Windows Explorer to transfer scans to your computer for use and backup
- Upload images to your Facebook account
- Order prints, enlargements or photo books from your local print shop via LifePics™
- Access Windows Explorer to delete scans from the SD memory card
- Restore color (hue, contrast, etc.) on old photos
- Access www.flip-pal.com and customer support

To launch the Flip-Pal™ Toolbox, power off the scanner, remove the SD memory card from the scanner and insert it in your computer's SD card slot. (If your computer does not have an SD card slot, insert the SD memory card into the supplied SD memory card to USB adaptor, then insert the adaptor into a USB slot on your computer.) After you insert the SD memory card into your computer, find the Flip-Pal™ drive location, open the folders if necessary and click on Toolbox or Toolbox.exe. This will vary based on your computer's operating system and configuration.

Windows users can access the Flip-Pal™ documentation from either the Toolbox main screen, or directly from the Documents folder on the SD card.

Mac Users

If you are using a Mac with Apple OS-X, you will find the Flip-Pal™ software for Mac in the Mac folder on the SD card. The Flip-Pal™ software enables you to:

- Stitch scans together to reconstruct larger originals with Flip-Pal™ EasyStitch
- Upload images to your Facebook account
- Access www.flip-pal.com and customer support

This software is found in a **Mac** folder on the SD card. See the NOTE above to make sure you have this software. To launch the Mac version of Flip-Pal™ software, remove the SD card from your scanner and insert it into an SD slot on your computer. On the desktop double-click on the Flip-Pal™ disk icon. In the Finder window, double-click on the Mac folder. Then double-click on EasyStitch or FlipPalFacebookUpload.

Mac users can access the Flip-Pal™ documentation from the Documents folder on the SD card.

IMPORTANT: If iPhoto launches when you insert the SD card into your computer, review the FAQ on this topic at www.flip-pal.com/FAQs.

How to Transfer and Delete Scans

Windows users: For Windows users, the **Browse Scans** button in Flip-Pal™ Toolbox opens Windows Explorer on your computer. You can then use Windows Explorer to:

- Transfer scans from the SD memory card to any folders on your computer
- Delete scans from the SD memory card. **Note:** This is the only method for deleting scans. Delete scans as you would any other file.

Mac users: Mac users will use standard Mac functionality for transferring and deleting scans.

NOTE: If you edit a scan (crop, rotate, etc.) and store it back on the SD memory card, the file will no longer be recognized or displayed by your scanner.

How to Stitch Large Originals with Flip-Pal™ EasyStitch Software

Flip-Pal™ EasyStitch software enables you to easily stitch together multiple 4x6" scans of a large original such as an 8x10" photo, scrapbook page or poster.

1. To start the EasyStitch software:
 - Windows: Start the Flip-Pal™ Toolbox, then click **Stitch Scans**.
 - Mac: On the desktop double-click on the **Flip-Pal™ disk icon**. In the Finder window, double-click on the **Mac folder**. Then double-click on **EasyStitch**.
2. Click **Select Files** in the center of the window, to select the files to be stitched together. To select multiple files, you can:
 - To select a range of files, click on the first image in the range, hold down the **SHIFT** key and click on the last image in the range.
 - To select individual files, hold the **CTRL** key (**COMMAND** key on a Mac) and click on each desired file.
3. Click **Open** at bottom right of the Open screen. The program automatically stitches the scans together into a single image. It then displays the stitched image using your default photo editing or viewing program, and automatically saves the stitched image in the same folder as the original images with the name **Stitch[first image]-[last image].jpg**, using the names of the first and last files you used.
4. If your default photo viewing program is also a photo editor, you can use it at this point to crop, rotate or make other edits to the image. Otherwise, you can use a photo editor at any point in the future. As a good practice, you may want to save the photo with a unique name by clicking **File**, then **Save As** or **Copy As**.

NOTE: If you stitch the same images again, the stitching software uses the same name as above, Stitch[first image]-[last image].jpg, over-writing any previous stitched image with that name.

Flip-Pal™ EasyStitch software is available for use with this product only.

Any commercial use, distribution, or resale of this software requires a license agreement with the University of British Columbia.

By using this software, the user agrees to the terms of the End-User Software License Agreement found in Appendix A of the Flip-Pal™ User's Guide.

How to Restore Color to Faded or Yellowed Photos

Windows users: Flip-Pal™ Toolbox for Windows provides color restoration software which enables you to increase the vibrancy of colors, as well as minimize the discoloration often found in old photos, or photos scanned out of albums whose cover sheets have yellowed.

1. Click **Restore Color** from the Toolbox
2. Click **Load**
3. Select the file you want to edit and click **Open**

4. The “restored” photo using the default settings is then displayed in the right hand window. If you are satisfied with the resulting photo, click **Save**, choose a file name and destination folder and click **Save** again.

Note: If you want to try other enhancement options, you can choose other “preset” options or use the Color Cast and Auto Gamma slider buttons to modify coloration and contrast manually, saving as described above.

How to Upload Scans to Facebook

The Flip-Pal™ Upload to Facebook software is an easy way to upload scans right to your Facebook account. When you run the software for the first time, it creates a new Album in your Photos section of Facebook. The album is titled “Flip-Pal mobile scanner Photos”.

1. To start the Upload to Facebook software:
 - Windows: Start the Flip-Pal™ Toolbox, then click **Upload Images to Facebook**.
 - Mac: On the desktop double-click on the **Flip-Pal™ disk icon**. In the Finder window, double-click on the **Mac folder**. Then double-click on **Flip-Pal Facebook Upload**.
2. You will see a screen that allows you to log in to your Facebook account, so you will need the appropriate email address and Facebook password. Note that you are still asked for these, even if you are currently logged in to Facebook. If you do not have a Facebook account, there is a link in the lower-left corner that lets you create one.
3. Click **Upload Files**. Select the image to be uploaded. To select multiple images, press the Shift or Ctrl key on your keyboard while clicking on each image that you want to select.
4. If you want to add tags or descriptions to the images, you will need to go to your Facebook account and do this using the Facebook tools.

How to Order Prints

Windows Users:

LifePics helps you find digital print services where you can upload your favorite Flip-Pal™ scans, then order prints, enlargements, photo books, calendars and more. You can either pick these up at a store, or have them mailed to you.

To order prints from LifePics:

1. Start the Flip-Pal™ Toolbox, then click **Prints, Enlargements, Photo Books**.
2. This takes you to the main page of LifePics.com.
3. Click **Order Prints & More** on the right side of the page.
4. Enter your zip code, or click on your state to find a retailer that offers digital printing and more.
5. Select a local retailer from the list.
6. Create a free online photo account and upload your images using the friendly uploading tool.
7. Order digital photo prints, which you can pick up at the store, or have delivered to your door.

Battery Information

Supported Batteries and Battery Life

The Flip-Pal™ mobile scanner requires four AA batteries. Supported batteries include:

Type of Battery	Approximate Number of Scans
Alkaline	150
Photo Lithium	450
Rechargeable	500 (NiMH 2000mAH capacity)

It is a good idea to have extra batteries on hand. Do not mix battery types, brands, or old and new batteries. Check the expiration dates printed on the batteries.

Replacing Batteries

When the screen displays the message “batteries too low to scan”, it is time to replace them. Turn off the scanner, press the release on the battery door and slide it in the direction of the arrow. Remove the old batteries, insert four new AA batteries and replace the door. Battery orientation is shown on the inside of the compartment.

The date/time, resolution, and power-saver timer settings are saved at power off. While the batteries are removed, the scanner’s internal clock is paused. After the batteries are replaced and the scanner is turned on, the scanner will display the date/time screen. You may update the settings or move to **Done** and press OK.

Extending Battery Life

In older models, to help conserve battery power, the display dims after 60 seconds of inactivity. Pressing any button returns the display to full brightness. After 1, 2 or 10 minutes of inactivity, the scanner turns off, depending on the Power-Saver Timer setting. To extend battery life, use one of the lower settings. The default setting is 2 minutes. (see Customized Settings – Chapter 2).

SD Memory Cards

The Flip-Pal™ mobile scanner comes with a 2GB SD memory card. This card:

- Stores your scans in the **DCIM** folder
- Contains Flip-Pal™ Software
- Stores your customized Home Screen in **MyScanner.JPEG**

NOTE: The Flip-Pal™ mobile scanner and the included SD Memory Card to USB adapter do not support the Write Protect capability of SD memory cards.

The typical file size for a 300 DPI (1 star) scan is 1.2MB, while a 600 DPI (2 star) scan is 1.6MB. This varies from one scan to the next. The included 2GB SD memory card has about 1.5GB available for storing scans, which is approximately **1200 scans** at 300 DPI, or **900 scans** at 600 DPI.

You can use any common SD or SDHC memory card to store your scans. We have tested SD cards up to 32 GB in size. When you use a new SD card for the first time, the scanner will create the directory structure it needs to store scans.

To copy Flip-Pal™ software to a new SD memory card, put the original SD memory card into your computer. Copy the contents of the SD memory card to your hard drive. Remove the original SD memory card and insert a new one, then copy the folders from your hard drive to the new SD memory card. Please see www.flip-pal.com for more information.

If you lose your Flip-Pal™ SD memory card, please go to www.flip-pal.com for information on how to download Flip-Pal™ software onto a new card.

Other Uses for the SD Memory Card

You can use the SD memory card in other devices, such as a printer, CD burner, digital picture frame or photo kiosk. Please visit www.flip-pal.com for more information.

Product Care

Exercise care when transporting your Flip-Pal™ mobile scanner to prevent the top cover, display, or bottom viewing window from getting scratched. You can purchase a carrying case or window protectors for the bottom viewing window at www.flip-pal.com.

You may clean the exterior surfaces of the scanner using a mild cleaning solution applied to a soft cloth. The glass scanner bed can be cleaned with mild soap or glass cleaner applied to a soft cloth. Do not pour or spray the solution directly onto the glass.

You may want to remove the batteries if you will not be using the unit for a long period of time. Note that the scanner's internal clock will be paused during that time and you will need to reset the time and date settings. Setting the time and date is important. It provides information for your computer's software to organize the files so you are able to find them later.

Operating System and Browser Support

Flip-Pal™ software is supported on Windows XP, Vista and Windows 7, as well as Mac OSX 10.4, 10.5, 10.6 and 10.7.

www.flip-pal.com supports the following browsers:

- Microsoft Internet Explorer version 7 and higher (Windows)
- Safari version 4 and higher (Windows, Macintosh)
- Mozilla Firefox version 3 and higher (Windows, Macintosh)
- Google Chrome version 2 and higher (Windows, Macintosh)
- Opera version 10 and higher (Windows)

Accessories and Replacement Parts

You can purchase additional accessories at www.flip-pal.com. Available accessories include carrying cases, window protector sheets, rechargeable batteries with charger and software.

Troubleshooting

There are a few errors that may occur when using your scanner.

Error Message	When it Can Occur	Meaning
Unable to show image	Review Mode	There is a file that is not a valid JPEG file. This can occur with a JPEG file created or edited by a digital camera or computer, or a stitched image.
No Readable Files	Review Mode	There are no scans on the SD memory card
Insert Card at Power On	When SD card is missing	Insert the SD card into the scanner and power on.
Memory Card Unreadable	Power On, Review Mode, Scanning	Memory card is unreadable. If it is defective, it will need to be reformatted or replaced.
Memory Card Full	After pressing SCAN	Not enough room on the SD memory card to store the scan. You will need to use a new SD memory card or transfer scans to your computer then delete them from the SD memory card.
Batteries Too Low to Scan	After pressing SCAN	Replace batteries
Self-Test Failure	Power On	Call Customer Support at 1-855-477-3547
Calibration Failure	Power On	Call Customer Support at 1-855-477-3547
Check Sum Failure	Power On	Call Customer Support at 1-855-477-3547

Customer Support

Website: www.flip-pal.com

Email: support@flip-pal.com

Phone: 1-855-477-3547

Hours: 9 am-5 pm Mountain Time

Limited Warranty

Couragent, Inc. warrants its products to be free from defects in material and workmanship, under normal non-commercial use for a period of one (1) year from the date of original retail purchase. Keep your original sales receipt. This dated proof of purchase will ensure your warranty coverage.

This warranty does not apply to any defects caused by negligence, misuse, accidents, acts of nature, or unauthorized modification or attempted repair. Cosmetic damage to case parts or to other parts that does not affect product function is not covered.

The Flip-Pal™ mobile scanner is a sensitive optical device, similar to a digital camera. Damage caused by dropping or other abuse of this device is not covered by this warranty.

Couragent, Inc. will repair, replace or, at its option, refund the purchase price of a defective product during the warranty period. Contact Customer Support at 855.477.3547 for service authorization. Please have ready the product receipt, product serial number (located on bottom of scanner), and a description of the problem (error message or physical defect). Replacement products may be new or factory refurbished items of the same or comparable value.

This Warranty applies only to equipment purchased in the United States or Canada.

Warranty coverage is only available from within the country where the products were originally purchased. You may be required to ship products, at your expense, to the authorized warranty service center for the country where the products were purchased.

Disclaimer

Couragent, Inc. assumes no responsibility for loss caused by deletion of data as a result of malfunction, dead battery, or repairs. Be sure to make backup copies of all important data on other media to protect against data loss.

Declaration of Conformity

This equipment complies with part 15 of the FCC Rules. Operation is subject to the following two conditions: (1) this device may not cause harmful interference, and (2) this device must accept any interference received, including interference that may cause undesired operation.

Appendix A – Flip-Pal™ EasyStitch End-User Software License Agreement

END-USER SOFTWARE LICENSE AGREEMENT

This End User License Agreement ("EULA") is a legal agreement between you (the "User", either an individual or individual legally representing or duly authorized by a legal entity to whom the rights defined in the present document are granted) and Couragent, Inc., a company with offices in Fort Collins, CO ("Company") for the accompanying software product, which includes computer software and may include other associated materials including media, printed materials, and "online" or electronic documentation (the "Software Product"). By installing, copying, or otherwise using the Software Product, the User agrees to be bound by the terms of this EULA. If User does not agree to the terms and conditions of this EULA, do not install or use the Software Product.

THE USER MUST READ THIS EULA PRIOR TO USE OR INSTALLATION OF THE SOFTWARE PRODUCT.

THE SOFTWARE PRODUCT IS PROTECTED BY INTELLECTUAL PROPERTY LAWS, INCLUDING BUT NOT LIMITED TO COPYRIGHT LAWS AND INTERNATIONAL COPYRIGHT TREATIES, AS WELL AS OTHER PATENT LAWS AND TREATIES. THE SOFTWARE PRODUCT IS LICENSED, NOT SOLD. THIS SOFTWARE PRODUCT IS BASED IN PART ON TECHNOLOGY PROTECTED BY US PATENT 6,711,293.

GRANT OF LICENSE (single user license)

Company hereby grants to User a personal, non-exclusive, non-transferable license (a "License") to use one (1) copy of the Software Product, including any updates thereto, and accompanying documentation, if any, provided by Company, according to the terms set forth below. This EULA may not be transferred or assigned in any manner, either directly or indirectly.

SCOPE OF USE

User may install and use one copy of the Software Product, on a single computer, and only for use with one portable image scanning device sold by the Company. The use of the Software Product is limited to use related to scanned images created by the portable image scanning device sold by the Company. The primary user of the computer on which the Software Product is installed may make a second copy for his or her exclusive use on a portable computer. A license for the Software Product may not be shared or used concurrently on different computers.

PROHIBITIONS

User may not: modify, prepare derivative works from, translate, reverse engineer, decompile, disassemble or otherwise derive source code from the Software Product; copy the Software Product (except as provided above) or the accompanying documentation; sell, rent, transfer, disclose, sublicense, distribute, make available or grant any rights in the Software Product (including any accompanying documentation) in any form to any person without the prior written consent of Company; remove any proprietary notices, labels, or marks on the Software Product (including any accompanying documentation); use the Software Product in any manner that infringes the intellectual property or other rights of another party; or use the Software Product to provide services to any third party.

RETENTION OF RIGHTS; TERMINATION

This EULA does not constitute a sale. This EULA does not grant to the User any right of ownership of the Software Product. All title, trade secrets, copyrights, patents and other intellectual rights to the Software Product, its accompanying documentation and any copy made by User remain with Company or its licensors or suppliers, and User hereby agrees to preserve and acknowledges the foregoing. User further agrees and acknowledges that unauthorized copying of the Software Product or the accompanying documentation, or failure to comply with any of the provisions hereof (each, a "Terminable Event"), will result in automatic termination of this License. In the event of a violation of this License by User, Company reserves and shall have available all legal remedies.

DISCLAIMER

Company, its licensors and suppliers shall have no liability for, nor obligation to indemnify User regarding actions alleging the infringement of proprietary rights by the Software Product. Company, its licensors and suppliers do not warrant that the operation of the Software Product will be uninterrupted or error free or that the Software Product will meet User's specific requirements.

THE USER ACKNOWLEDGES AND AGREES THAT THE SOFTWARE PRODUCT IS PROVIDED TO THE USER "AS IS", AND THAT THE COMPANY, ITS LICENSORS AND SUPPLIERS MAKE NO REPRESENTATIONS AND EXTEND NO WARRANTIES OF ANY KIND, EITHER EXPRESS OR IMPLIED. THERE ARE NO EXPRESS OR IMPLIED WARRANTIES OF MERCHANTABILITY OR FITNESS OF THE SOFTWARE PRODUCT FOR A PARTICULAR PURPOSE, OR THAT THE USE OF THE SOFTWARE PRODUCT WILL NOT INFRINGE ANY PATENT, COPYRIGHT, TRADEMARK OR OTHER RIGHTS. THE COMPANY, ITS LICENSORS AND SUPPLIERS DO

NOT WARRANT THAT THE SOFTWARE PRODUCT IS FREE FROM MALFUNCTIONS, NOR THAT ANY MALFUNCTIONS CAN OR WILL BE CORRECTED OR THAT THE COMPANY, ITS LICENSORS OR SUPPLIERS WILL DEVELOP OR PROVIDE TO THE USER ANY OPERATIONS, CAPABILITIES OR FEATURES NOT PRESENT IN THE VERSION OF THE SOFTWARE PRODUCT FIRST DELIVERED TO THE USER UNDER THIS EULA.

LIMITATION OF LIABILITY

IN NO EVENT WILL COMPANY, ITS LICENSORS OR SUPPLIERS BE LIABLE TO USER OR ANY OTHER PERSON OR ENTITY FOR ANY LIABILITY, LOSS OR DAMAGES CAUSED OR ALLEGED TO HAVE BEEN CAUSED, EITHER DIRECTLY OR INDIRECTLY, BY THE SOFTWARE OR DOCUMENTATION. WITHOUT LIMITING THE FOREGOING, IN NO EVENT WILL COMPANY, ITS LICENSORS OR SUPPLIERS BE LIABLE FOR ANY LOST IMAGE, REVENUE, PROFIT, BUSINESS INTERRUPTION OR DATA, OR FOR SPECIAL, INDIRECT, CONSEQUENTIAL, INCIDENTAL OR PUNITIVE DAMAGES, HOWEVER CAUSED AND REGARDLESS OF THE THEORY OF LIABILITY, ARISING OUT OF OR RELATED TO THE USE OF OR INABILITY TO USE THE SOFTWARE OR DOCUMENTATION, EVEN IF COMPANY, ITS LICENSORS OR SUPPLIERS HAVE BEEN ADVISED OF THE POSSIBILITY OF SUCH DAMAGES. THE COMPANY'S, AND ITS LICENSORS' AND SUPPLIERS', LIABILITY UNDER THE TERMS OF OR IN RELATION TO THE SOFTWARE, THE DOCUMENTATION OR UNDER THIS EULA ARE STRICTLY LIMITED TO THE PURCHASE PRICE PAID BY THE USER FOR THE SOFTWARE.

TERMINATION

This EULA is in force until terminated. User may terminate this EULA at any time. This EULA will be terminated automatically if User fails to abide by any provisions of this EULA. The provisions of this EULA are severable in that if any provision in the EULA is determined to be invalid or unenforceable under any controlling body of law that will not affect the validity or enforceability of the remaining provisions of the EULA. If this EULA is terminated, User shall delete and cease to use all copies of the Software Product.

GENERAL PROVISIONS

This Agreement constitutes the entire agreement between Company and User and supersedes all prior agreements, understandings, communications, advertising, proposals or representations, oral or written, by either party.

No modification of this EULA will be binding, unless in writing and signed by an authorized representative of each party.

This License Agreement shall be governed by the laws of Colorado, USA.

Couragent, Inc.

Revision 2-0, October 2011